

Article datasheet

Blade Terminal 4.8x0.8 | 90° Tin-Plated Brass

Article-No.: 019.48.151

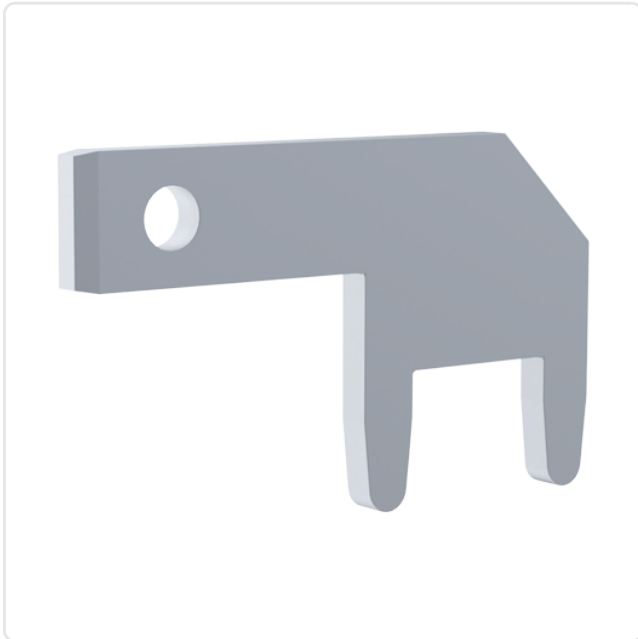

Image may be similar

Bending Angle [°]:	90
Finish:	Tin-Plated
Grid [mm]:	5.08
Material:	Brass
Material Group:	Messing
PCB Hole Ø [mm]:	1.4
Plug-In Length [mm]:	7
Size [mm]:	4.8x0.8
Tabs:	1
Weight:	0.53g
Conformities:	<div style="display: flex; gap: 10px;"> <div style="border: 1px solid green; padding: 2px; font-size: 8px;">Reach COMPLIANT</div> <div style="border: 1px solid green; padding: 2px; font-size: 8px;">RoHS COMPLIANT</div> <div style="border: 1px solid green; padding: 2px; font-size: 8px;">SVHC COMPLIANT</div> </div>



You can find all
information on the web on
our article detail page

Would you like individual advice?

We look forward to your email to products@ettinger.de.

Subject to change and errors.

