

Article datasheet

Parallel Connector DIN 46341-A10 Copper tinned without insulation - 10mm²

Article-No.: 018.70.065

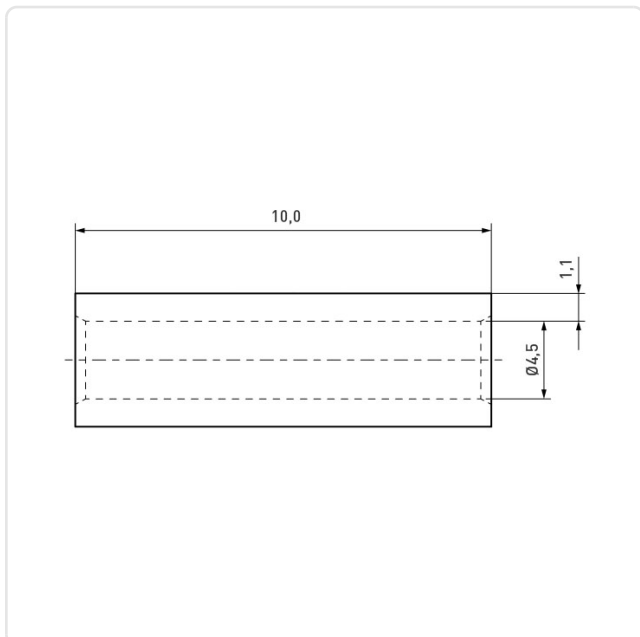

Image may be similar

DIN/ISO: DIN46341
Finish: Tin-Plated
Length [mm]: 10
Material: Electrolytic Copper
Wire Cross Section [mm²]: 6.0-10
Weight: 1.59g
Conformities:



You can find all
information on the web on
our article detail page



Would you like individual advice?

We look forward to your email to products@ettinger.de.

Subject to change and errors.