

Article datasheet

## Self-Clinching Stud M4x10.0 Tin-Plated Phosphor Bronze

Article-No.: 004.67.455



Image may be similar

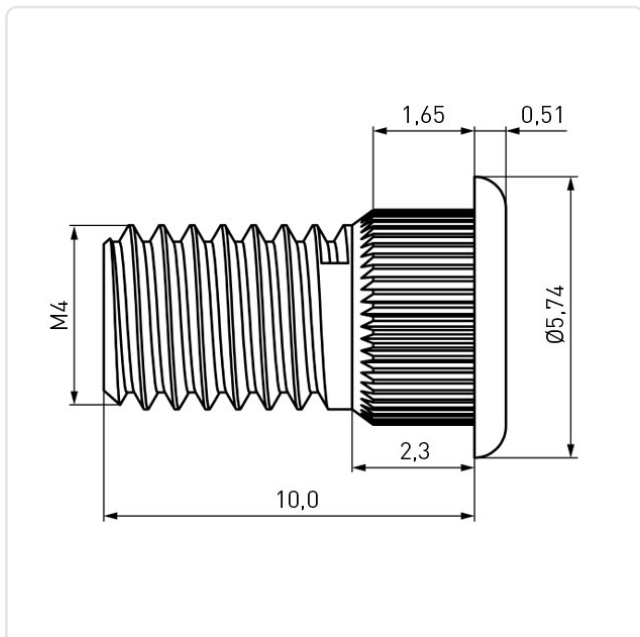

|                             |                 |
|-----------------------------|-----------------|
| Area of Application:        | For Plastics    |
| Finish:                     | Tin-Plated      |
| Head Diameter [mm]:         | 5.74            |
| Length [mm]:                | 10              |
| Material:                   | Phosphor Bronze |
| Material Group:             | Phosphor Bronze |
| Minimum Edge Distance [mm]: | 4.1             |
| Panel Hole Ø [mm]:          | 4.2             |
| Panel Thickness [mm]:       | 1,5             |
| Thread Size:                | M4              |
| Weight:                     | 1.06g           |
| Conformities:               |                 |



You can find all  
information on the web on  
our article detail page

Would you like individual advice?

We look forward to your email to [products@ettinger.de](mailto:products@ettinger.de).

Subject to change and errors.