

Article datasheet

Cut-Out Cover for D-Sub 15-polig Metal Housing for EMC Application

Article-No.: 076.76.159

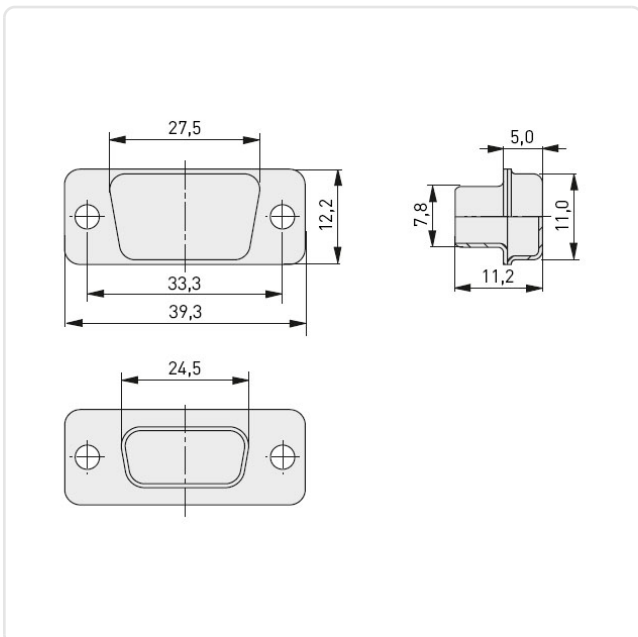

Image may be similar

Material: Steel
Material Group: Steel
Model: D-Sub
Mounting Hole [mm]: 3.2
Width [mm]: 39.3
Weight: 3.9g
Conformities:



You can find all information on the web on our article detail page



Would you like individual advice?

We look forward to your email to products@ettinger.de.

Subject to change and errors.