

Article datasheet

Blade Terminal 2.8x0.8 | 90° Tin-Plated Brass

Article-No.: 019.28.173

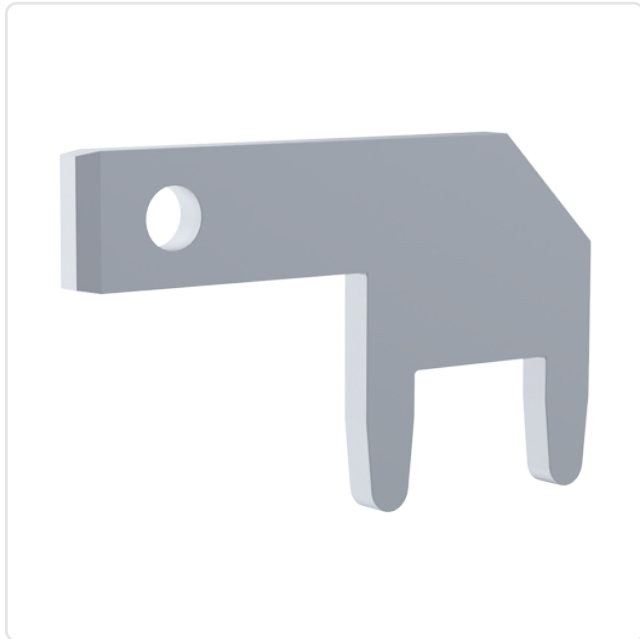

Image may be similar

Bending Angle [°]: 90
Finish: Tin-Plated
Grid [mm]: 5.08
Material: Brass
Material Group: Brass
PCB Hole Ø [mm]: 1.3
Size [mm]: 2.8x0.8
Tabs: 1
Weight: 0.35g
Conformities:



You can find all
information on the web on
our article detail page

Would you like individual advice?

We look forward to your email to products@ettinger.de.

Subject to change and errors.

